

Erina High School

Evacuation Map

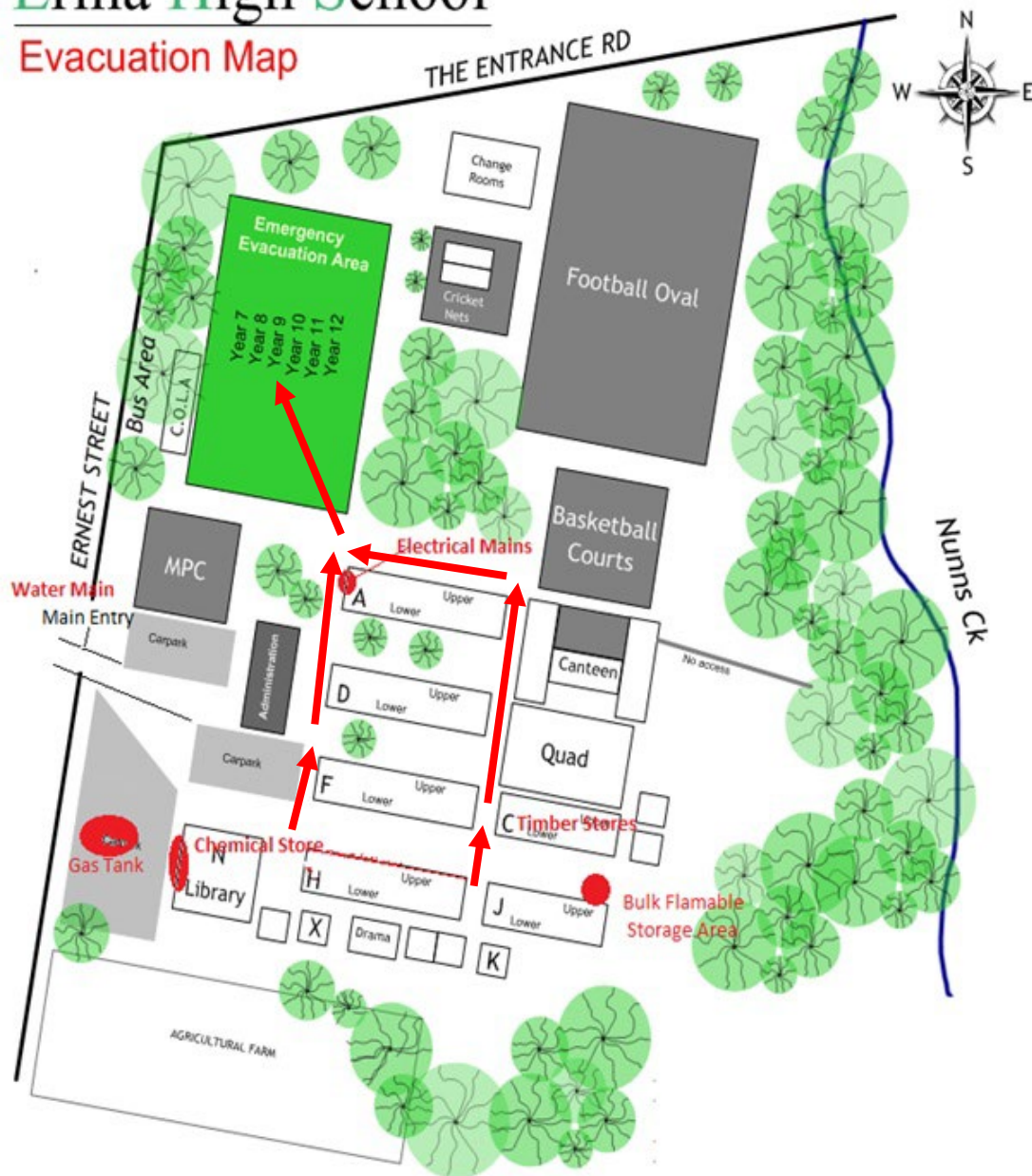

Emergency Management Plan

Evacuation: **Continuous Bell. (Get Out)**

- Students and teacher proceed via the shortest route to the northern (far end) of the small oval.
 - Upper floors (East side)
 - Lower floors (West side)
- Take bags with you.
- Students sit alphabetically in roll call groups. (Year 7 - Woodport side to Year 12 - Cricket Net side)
- Remain seated on the oval until given further instructions by the Deputy Principal.

Lockdown: **Single Bell repeated - 30sec. (Hide)**

- Students and teachers stay in room.
- If outside, move to the closest classroom.
- Lock door, lower blinds.
- Students sit on floor out of sight, preferable under tables.
- Remain silent.
- Emergency over. (2 x 10 sec bells)
- Move to MPC for whole school assembly, sit alphabetically in roll call classes.
- Remain seated until given further instructions by the Deputy Principal
- Continuous bell will sound if progressing to evacuation.

